

By the official action of the City Council, the following changes were made in the Official Zoning Map.

REVISIONS

NUMBER	ORDINANCE DATE	ORDINANCE NUMBER	REVISION DATE	BY:
1	OCTOBER 14, 1991	327	5-4-94	SCR
2	NOVEMBER 4, 1991	328	5-4-94	SCR
3	APRIL 26, 1993	339	9-14-94	SCR
4	AUGUST 9, 1993	344	5-4-94	SCR
5	JANUARY 24, 1994	349	5-4-94	SCR
6	MARCH 7, 1994	354	5-4-94	SCR
7	MARCH 21, 1994	357	5-4-94	SCR
8	MARCH 19, 1994	360	8-24-95	DMW
9	JULY 11, 1994	362	8-24-95	DMW
10	OCTOBER 10, 1994	365	8-24-95	DMW
11	NOVEMBER 14, 1994	366	8-24-95	DMW
13	JUNE 12, 1995	380	8-24-95	DMW
14	JUNE 26, 1995	381	1-26-96	LLS
15	JULY 10, 1995	384	1-26-96	LLS
16	AUGUST 28, 1995	385	1-26-96	LLS
17	JANUARY 8, 1996	396	1-26-96	LLS
18	MAY 15, 1997	418, 419	5-20-97	BDB
19	SEPTEMBER 8, 1997	422	8-12-98	DMW
20	MARCH 23, 1998	428	8-12-98	DMW
21	JUNE 22, 1998	429	8-12-98	DMW
22	SEPTEMBER 27, 1999	445	11-11-99	DMW
23	JANUARY 10, 2000	455	1-26-00	ASL
24	JULY 12, 1999	444	12-21-00	DMW
25	NOVEMBER 8, 1999	451	12-21-00	DMW
26	JUNE 12, 2000	459	12-21-00	DMW
27	SEPTEMBER 11, 2000	460	12-21-00	DMW
28	NOVEMBER 13, 2000	462	12-21-00	DMW
29	SEPTEMBER 26, 2002	475	8-19-03	ALA
30	DECEMBER 2, 2002	477	8-19-03	ALA
31	APRIL 23, 2003	478	8-19-03	ALA
32	MAY 10, 2004	485	04-01-05	ALA
33	DECEMBER 13, 2004	492	04-01-05	ALA
34	JANUARY 10, 2005	493	04-01-05	ALA
35	MAY 9, 2005	495	11-14-05	DMW
36	MAY 9, 2005	497	11-14-05	DMW
37	NOVEMBER 28, 2005	502	10-03-06	ALA
38	JULY 10, 2006	504	10-03-06	ALA
39	JANUARY 3, 1994	346	10-03-06	ALA
40	NOVEMBER 27, 2006	509	03-21-07	ALA
41	JUNE 11, 2007	515	12-26-08	ALA
42	JUNE 9, 2008	520	12-26-08	ALA
43	OCTOBER 22, 2008	522	12-26-08	ALA

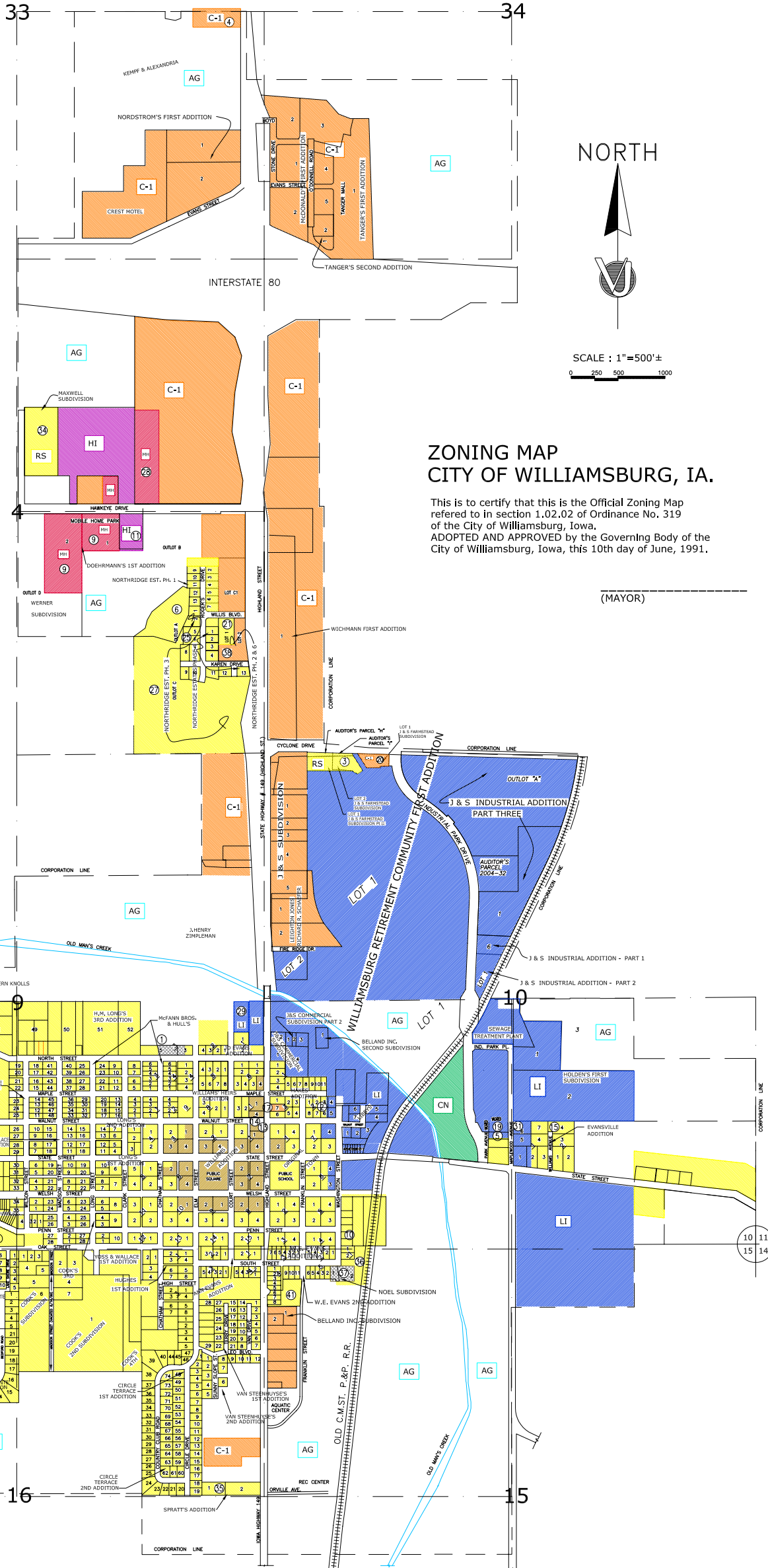

Legend

Scale: 1" = 500'±

Corporate Line _____
Section Line _____

- RS — RESIDENTIAL DISTRICT
- AG — AGRICULTURAL DISTRICT
- MH — MOBILE HOME DISTRICT
- C-1 — ARTERIAL COMMERCIAL DISTRICT
- C-2 — CENTRAL BUSINESS COMMERCIAL DISTRICT
- LI — LIGHT INDUSTRIAL DISTRICT
- HI — HEAVY INDUSTRIAL DISTRICT
- CN — CONSERVATION DISTRICT
- R-ZL — ZERO-LOT LINE DISTRICT

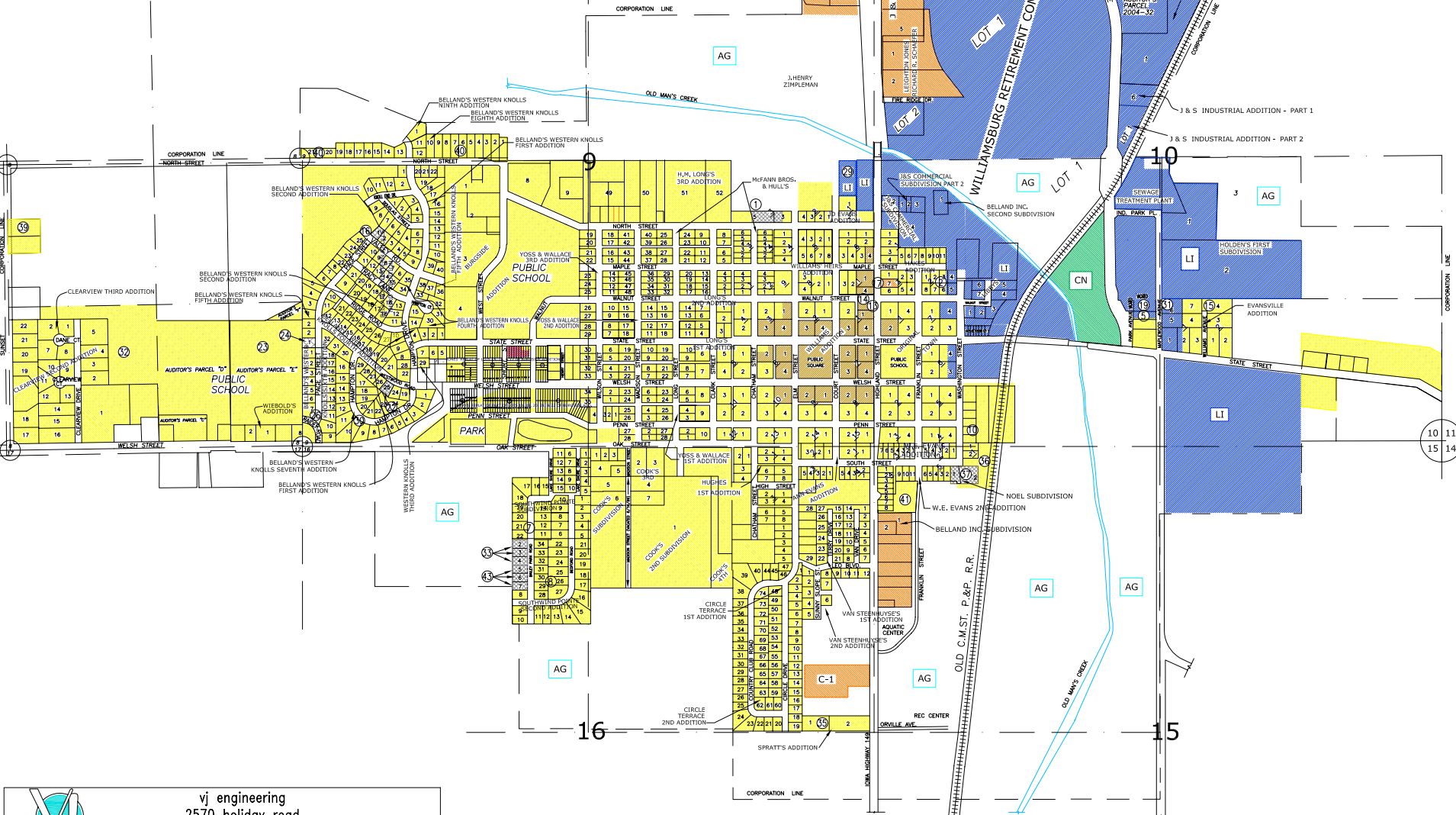

vj engineering
2570 holiday road
coralville, iowa - 319-338-4939